

## NEW generation of maritime Olorin monitors in the classic form factor.

**VLD159**

15"

**VLD179**

17"

**VLD199**

19"

**VLD229**

21.5"



## Olorin's new MAV main board platform

### 9V to 36V

Olorin's new monitors can be connected with 9V to 36V, making them much more versatile for configurations with different DC setups.

### Command & Control

Olorin's new lineup of monitors have support for RS232 command & control for easier adjustment of the dimming and settings.

### HDMI & DisplayPort

The VLDxx9 lineup of monitors have support for modern video standards such as HDMI and DP, along with legacy inputs such as DVI, VGA and CVBS (BNC).

Nirol Professional Displays B.V.  
Ippelseweg 15 b  
4255 HW Nieuwendijk NL  
+31 (0)183-505064  
www.nirol.nl



# Fully featured maritime monitors with dimming and optional sunlight readable filter

## Dimming



Olorin monitors are fully dimmable, this means that they keep the contrast when you decrease the brightness from 100 to 0%, keeping the helmsman's vision intact during complete darkness.

## Sunlight readable



The monitors can be fitted with a Sunlight Readable filter, a polarizing screen layer which makes the monitors fully readable in strong sunlight, making important information always clearly visible.

## Touch panel



Interactive touch screens are a common tool in our everyday life, Olorin monitors are designed to be easily customized with multi touch for environments where there's no room for a keyboard or mouse.

## External OSD



External control for OSD and dimming, connected via RJ45 or RS232. Perfect solution for remote adjustments of monitors. Olorin's high end models have GPIO for software integration.

## Mounting frames

Olorin offers a variety of mounting solutions, such as flush mounting, These are prepared with external OSD for dimming. Olorin also offers mounting arms and solid base units that can be fitted on a table or in the ceiling.

## Crystal clear imaging



Olorin strive for high quality imaging and as such, use high end VA and IPS displays to secure your work environment. Olorin's 27" and 55" monitors have a color depth of 1.07 Billion, which means reliable clarity.

## Picture by Picture



Olorin 27" and 55" monitors with Ultra HD resolution can output a total of four inputs at the same time with Picture in Picture. These models are also very versatile with Zoom and Profile functionality.

## Varied input options

The world is going digital and Olorin is no exception, we offer advanced video monitors with DVI, DisplayPort but also CVBS (BNC) and S-video (Mini DIN) for legacy systems.

# Olorin VLD159



Olorin VLD159 is designed for specialists in maritime and other demanding environments where rugged equipment is of the utmost importance.

## Excellent image quality

Olorin VLD159 features a standard XGA resolution which makes it compatible with the majority of hardware out there. The monitor has optional anti-reflective (Sunlight readable) filter for sunny days.

## Connectivity

Olorin VLD159 has multiple video inputs for users who want to get the most out of their monitor. It supports DisplayPort, HDMI, DVI and analog inputs such as VGA and CVBS. The monitor can also be connected to Olorin's external OSD for dimming.

This monitor also has optional PCAP multi touch for user interaction.

## Suitable for demanding environments

The monitor has a rugged construction and optional protective glass in order to be used in working environments such as maritime. Olorin VLD159 features a dimmable backlight, to make sure the operator can work even in complete darkness on the sea without having the monitor's contrast being compromised.

## 15" Monitor with Dimming

- 15" monitor with 1024 x 768 resolution
- Dimming for night time operation
- Multiple video inputs for a variety of equipment

## Specification

<b>LCD Panel</b>	Backlight Type	WLED
	Screen Technology	TN
	Surface Treatment	Antiglare, Hard coating (3H)
	Screen Size, Diagonal	15.0"
	Screen Size, H/V	304.128 x 228.096 mm
	Aspect Ratio	4:3
	Resolution	1024 x 768, XGA
	Color Depth	262K/16.2M, 60% NTSC
	Contrast Ratio	800:1 (Typ.) (TM)
	Luminance	350 cd/m <sup>2</sup> (Typ.)
	Viewing Angles	160 / 150 (Typ.)
<b>Display Modes</b>	Response Time	8 ms (Typ.)
	Refresh Rate	60 Hz
	Temperature	Cool, Neutral, Warm, User
<b>Features</b>	Dimming	Olorin Dimming, 0 to 100%
	Video Scaling	Full, 1:1, 4:3, 5:4, 16:9
	Video Inputs	DisplayPort
<b>Video Inputs</b>	DVI	DVI-I 29 pin x1 (DVI-A/DVI-D)
	HDMI	HDMI x 1
	CVBS	BNC x 1
	Control Inputs	Serial Command, RS-232
<b>Control Inputs</b>	Olorin External OSD	RJ45 x 1
	Touch Panel	Touch Type
	Touch Input, USB	PCAP (Optional)
<b>Touch Panel</b>	Touch Input, RS-232	USB-B x 1
	Touch Input, RS-232	D-sub 9 pin x 1
	USB	Firmware Upload
<b>Audio</b>	Audio Input	Micro USB x 1
	Speakers	Phone Jack 3.5mm x 1
<b>Power</b>	Speakers	2W x 2
	Power Input Type	External adapter
	Power Input Rating	100-240Vac, 1.8A, 50-60 Hz
	Adapter Power Output Rating	12V 4.5 A
	DC Input	9V~36V
	DC Connector	4 Pin
<b>Power</b>	Power consumption	Full Brightness: 25 W
		Power Saving: 1.5 W

<b>Mechanical</b>	Dimensions w/o Base Unit	347.43 x 271.43 x 58 mm
	Weight w/o Base Unit	2.8 (Approx) Kgs
	Housing Color	Black
	Housing Material	Plastic (PC+ABS)
	IP Rating *	IP 65 (Front bezel only, optional)
	Mounting Standard, VESA	100 x 100 mm
	OSD Interface	Potentiometer on Right Side
	OSD Lock	Yes
	Anti Reflective Film	Sunlight readable (optional)
	Screen Protection	Glass True Flat (optional)
	Security slot	Kensington Security Slot
<b>Compliance</b>	Ground bolt	Potential equalization bolt
	EU	CE (EN62368-1, EN55032/EN55035, Rohs, WEEE)
<b>Warranty</b>	EU Energy efficiency class	G
	DOA	Three (3) months, max. 500 h.
	Standard	Two (2) years

## Order no. Monitor

Order no.	Order no. Dimming Kit	Description
VLD15906	VLD15906D	Default
VLD15906S	VLD15906DS	w/ Sunlight readable filter
VLD15906GTF	VLD15906DGTF	w/ Screen Protection IP65 *
VLD15906PCAP	VLD15906DPCAP	w/ PCAP Touch panel IP65 *

## Order no. Accessories

Order no.	Description
XAVLD98415	Flush mounting frame
XAVL22012	Base unit, standard desktop
XAVL98200	Multi attachment Slim
XAVL98201	Multi attachment
XAVL9850x	External OSD (1, 2 or 4 ports)
XAVL99035	DVI to VGA & DVI splitter cable
XAVL99041	12V 4-pin cable (included with Dimming Kit)

# VistaLine VLD159

## Measurements

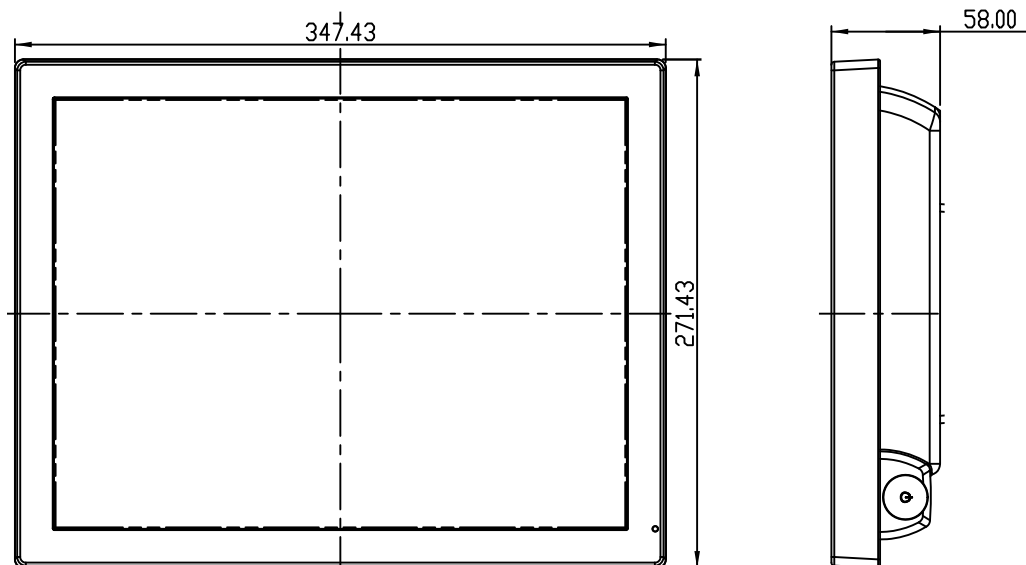

## Measurements for Flush mounting frame

Order no. : **XAVLD98415**

	Outer dimensions	Cut out dimensions
<b>Width</b>	393 mm	355 mm
<b>Height</b>	317 mm	276 mm

Additional cut out for OSD circuit and back plate might be necessary.

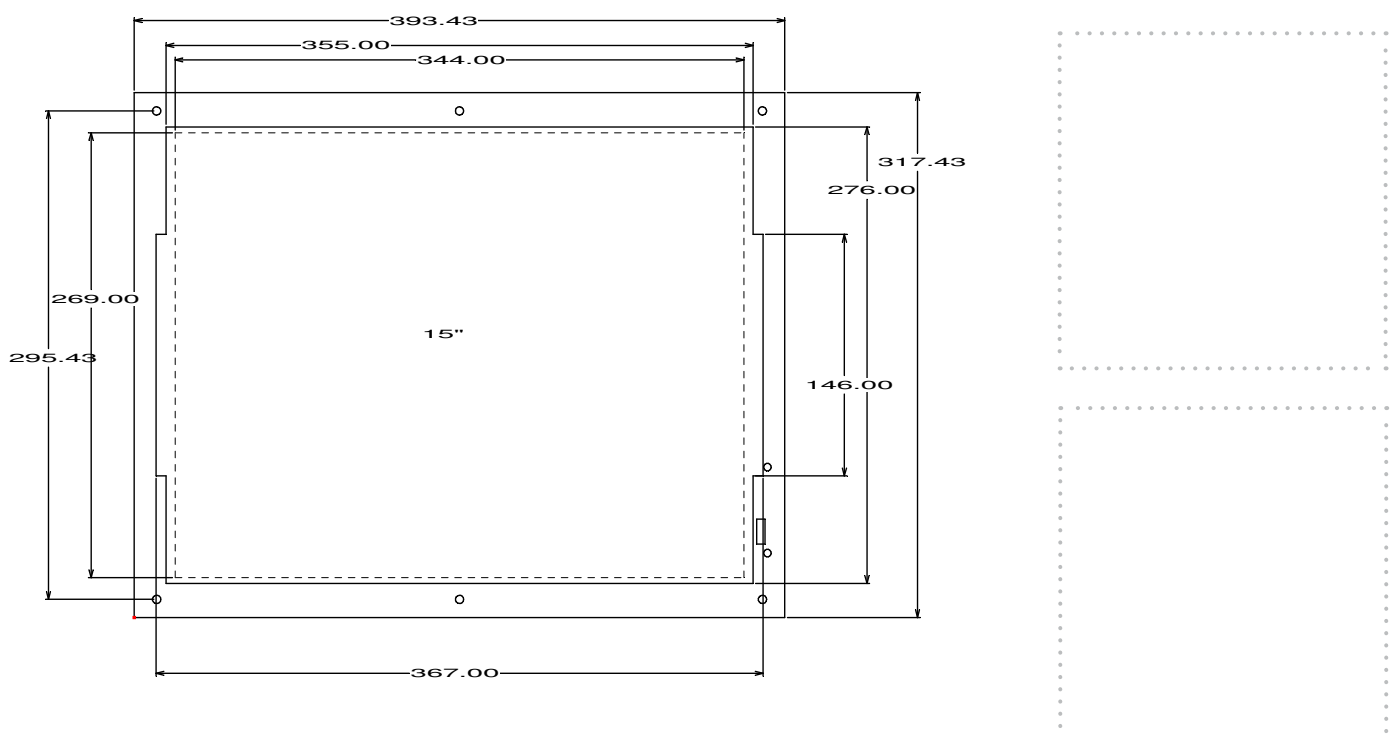



# Olorin VLD179



## 17" Monitor with Dimming

- 17" monitor with 1280 x 1024 resolution
- Dimming for night time operation
- Multiple video inputs for a variety of equipment

## Specification

<b>LCD Panel</b>	Backlight Type	WLED
	Screen Technology	TN
	Surface Treatment	Antiglare, Hard coating (3H)
	Screen Size, Diagonal	17.0"
	Screen Size, H/V	337.92 x 270.336 mm
	Aspect Ratio	5:4
	Resolution	1280 x 1024, SXGA
	Color Depth	16.7M, 72% NTSC
	Contrast Ratio	1000:1 (Typ.) (TM)
	Luminance	350 cd/m <sup>2</sup> (Typ.)
	Viewing Angles	170 / 160 (Typ.)
	Response Time	5 ms (Typ.)
	Refresh Rate	60 Hz
	Temperature	Cool, Neutral, Warm, User
<b>Display Modes</b>	Temperature	Cool, Neutral, Warm, User
<b>Features</b>	Dimming	Olorin Dimming, 0 to 100%
	Video Scaling	Full, 1:1, 4:3, 5:4, 16:9
<b>Video Inputs</b>	DisplayPort	DisplayPort x 1
	DVI	DVI-I 29 pin x1 (DVI-A/DVI-D)
	HDMI	HDMI x 1
	CVBS	BNC x 1
<b>Control Inputs</b>	Serial Command, RS-232	D-sub 9 pin x 1
	Olorin External OSD	RJ45 x 1
<b>Touch Panel</b>	Touch Type	N/A
	Touch Input, USB	-
	Touch Input, RS-232	-
<b>USB</b>	Firmware Upload	Micro USB x 1
<b>Audio</b>	Audio Input	Phone Jack 3.5mm x 1
	Speakers	2W x 2
<b>Power</b>	Power Input Type	External adapter
	Power Input Rating	100-240Vac, 1.8A, 50-60 Hz
	Adapter Power Output Rating	12V 4.5 A
	DC Input	9V~36V
	DC Connector	4 Pin
	Power consumption	Full Brightness: 25 W Power Saving: 1.5 W

Olorin VLD179 is designed for specialists in maritime and other demanding environments where rugged equipment is of the utmost importance.

### Excellent image quality

Olorin VLD179 features a standard SXGA resolution which makes it compatible with the majority of hardware out there.

### Connectivity

Olorin VLD179 has multiple video inputs for users who want to get the most out of their monitor. It supports DisplayPort, HDMI, DVI and analog inputs such as VGA and CVBS. The monitor can also be connected to Olorin's external OSD for dimming.

### Suitable for demanding environments

The monitor has a rugged construction and optional protective glass in order to be used in working environments such as maritime. Olorin VLD179 features a dimmable backlight, to make sure the operator can work even in complete darkness on the sea without having the monitor's contrast being compromised.

<b>Mechanical</b>	Dimensions w/o Base Unit	385 x 317 x 62.8 mm
	Weight w/o Base Unit	3.8 (Approx) Kgs
	Housing Color	Black
	Housing Material	Plastic (PC+ABS)
	IP Rating *	IP 65 (Front bezel only, optional)
	Mounting Standard, VESA	100 x 100 mm
	OSD Interface	Potentiometer on Right Side
	OSD Lock	Yes
	Anti Reflective Film	N/A
	Screen Protection	Glass True Flat (Optional)
<b>Compliance</b>	Security slot	Kensington Security Slot
	Ground bolt	Potential equalization bolt
	EU	CE (EN62368-1, EN55032/EN55035, Rohs, WEEE)
	EU Energy efficiency class	G
<b>Warranty</b>	DOA	Three (3) months, max. 500 h.
	Standard	Two (2) years

## Order no. Monitor

Order no.	Order no. Dimming Kit	Description
VLD17906	VLD17906D	Default
VLD17906GTF	VLD17906DGTF	w/ Screen Protection IP65 *

## Order no. Accessories

Order no.	Description
XAVLD98417	Flush mounting frame
XAVL22012	Base unit, standard desktop
XAVL98200	Multi attachment Slim
XAVL98201	Multi attachment
XAVL9850x	External OSD (1, 2 or 4 ports)
XAVL99035	DVI to VGA & DVI splitter cable
XAVL99041	12V 4-pin cable (included with Dimming Kit)

VistaLine VLD179

Measurements

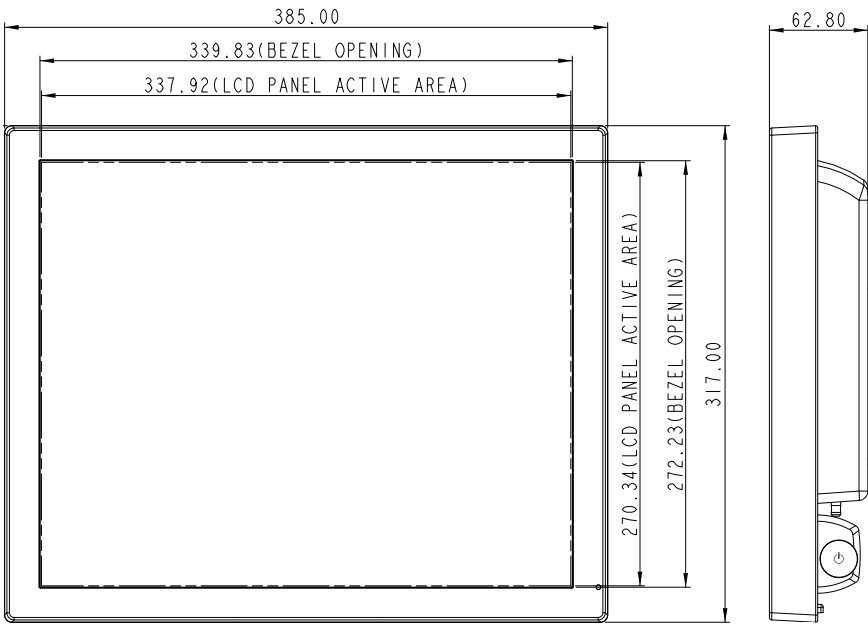

Measurements for Flush mounting frame

Order no. : XAVLD98417

	Outer dimensions	Cut out dimensions
Width	432 mm	394 mm
Height	363 mm	324 mm

Additional cut out for OSD circuit and back plate might be necessary.

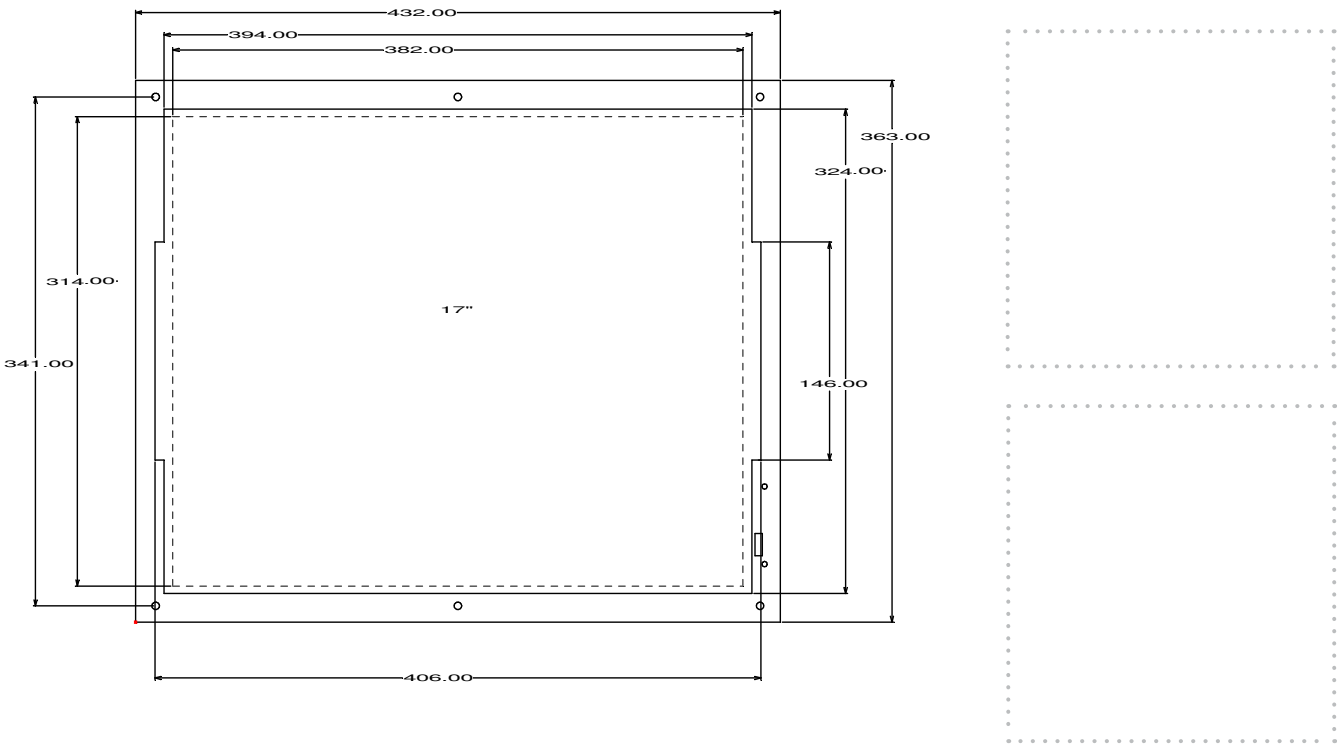



# Olorin VLD199



## 19" Monitor with Dimming

- 19" monitor with 1280 x 1024 resolution
- Dimming for night time operation
- Multiple video inputs for a variety of equipment

## Specification

<b>LCD Panel</b>	Backlight Type	WLED
	Screen Technology	AHVA
	Surface Treatment	Antiglare
	Screen Size, Diagonal	19.0"
	Screen Size, H/V	376.32 x 301.056 mm
	Aspect Ratio	5:4
	Resolution	1280 x 1024, SXGA
	Color Depth	16.7M, 72% NTSC
	Contrast Ratio	1000:1 (Typ.) (TM)
	Luminance	300 cd/m <sup>2</sup> (Typ.)
	Viewing Angles	178 / 178 (Typ.)
	Response Time	25 ms (Typ.)
<b>Display Modes</b>	Refresh Rate	60 Hz
	Temperature	Cool, Neutral, Warm, User
<b>Features</b>	Dimming	Olorin Dimming, 0 to 100%
	Video Scaling	Full, 1:1, 4:3, 5:4, 16:9
<b>Video Inputs</b>	DisplayPort	DisplayPort x 1
	DVI	DVI-I 29 pin x1 (DVI-A/DVI-D)
	HDMI	HDMI x 1
	CVBS	BNC x 1
<b>Control Inputs</b>	Serial Command, RS-232	D-sub 9 pin x 1
	Olorin External OSD	RJ45 x 1
<b>Touch Panel</b>	Touch Type	PCAP (Optional)
	Touch Input, USB	USB-B x 1
	Touch Input, RS-232	D-sub 9 pin x 1
<b>USB</b>	Firmware Upload	Micro USB x 1
<b>Audio</b>	Audio Input	Phone Jack 3.5mm x 1
	Speakers	2W x 2
<b>Power</b>	Power Input Type	External adapter
	Power Input Rating	100-240Vac, 1.8A, 50-60 Hz
	Adapter Power Output Rating	12V 4.5 A
	DC Input	9V~36V
	DC Connector	4 Pin
	Power consumption	Full Brightness: 35W Power Saving: 1.5W

Olorin VLD199 is designed for specialists in maritime and other demanding environments where rugged equipment is of the utmost importance.

### Excellent image quality

Olorin VLD199 features a standard SXGA resolution which makes it compatible with the majority of hardware out there. The monitor has optional anti-reflective (Sunlight readable) filter for sunny days.

### Connectivity

Olorin VLD199 has multiple video inputs for users who want to get the most out of their monitor. It supports DisplayPort, HDMI, DVI and analog inputs such as VGA and CVBS. The monitor can also be connected to Olorin's external OSD for dimming.

This monitor also has optional PCAP multi touch for user interaction.

### Suitable for demanding environments

The monitor has a rugged construction and optional protective glass in order to be used in working environments such as maritime. Olorin VLD199 features a dimmable backlight, to make sure the operator can work even in complete darkness on the sea without having the monitor's contrast being compromised.

<b>Mechanical</b>	Dimensions w/o Base Unit	429.2 x 354.21 x 65 mm
	Weight w/o Base Unit	4.7 (Approx) Kgs
	Housing Color	Black
	Housing Material	Plastic (PC+ABS)
	IP Rating *	IP 65 (Front bezel only, optional)
	Mounting Standard, VESA	100 x 100 mm
	OSD Interface	Potentiometer on Right Side
	OSD Lock	Yes
	Anti Reflective Film	Sunlight readable (Optional)
	Screen Protection	Glass True Flat (Optional)
<b>Compliance</b>	Security slot	Kensington Security Slot
	Ground bolt	Potential equalization bolt
	EU	CE (EN62368-1, EN55032/EN55035, Rohs, WEEE)
	EU Energy efficiency class	G
<b>Warranty</b>	DOA	Three (3) months, max. 500 h.
	Standard	Two (2) years

## Order no. Monitor

Order no.	Order no. Dimming Kit	Description
VLD19906	VLD19906D	Default
VLD19906S	VLD19906DS	w/ Sunlight readable filter
VLD19906GTF	VLD19906DGTF	w/ Screen protection IP65 *
VLD19906PCAP	VLD19906DPCAP	w/ PCAP Touch panel IP65 *

## Order no. Accessories

Order no.	Description
XAVLD98419	Flush mounting frame
XAVL22012	Base unit, standard desktop
XAVL98200	Multi attachment Slim
XAVL98201	Multi attachment
XAVL9850x	External OSD (1, 2 or 4 ports)
XAVL99035	DVI to VGA & DVI splitter cable
XAVL99041	12V 4-pin cable (included with Dimming Kit)

VistaLine VLD199

Measurements

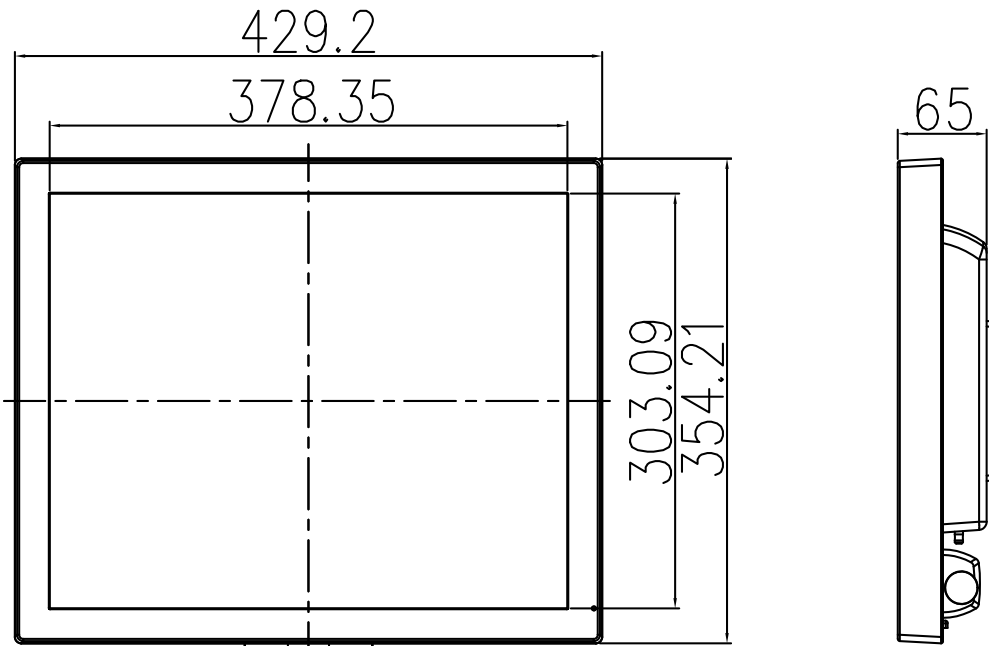

Measurements for Flush mounting frame

Order no. : XAVLD98419

	Outer dimensions	Cut out dimensions
Width	476 mm	440 mm
Height	400 mm	363 mm

Additional cut out for OSD circuit and back plate might be necessary.

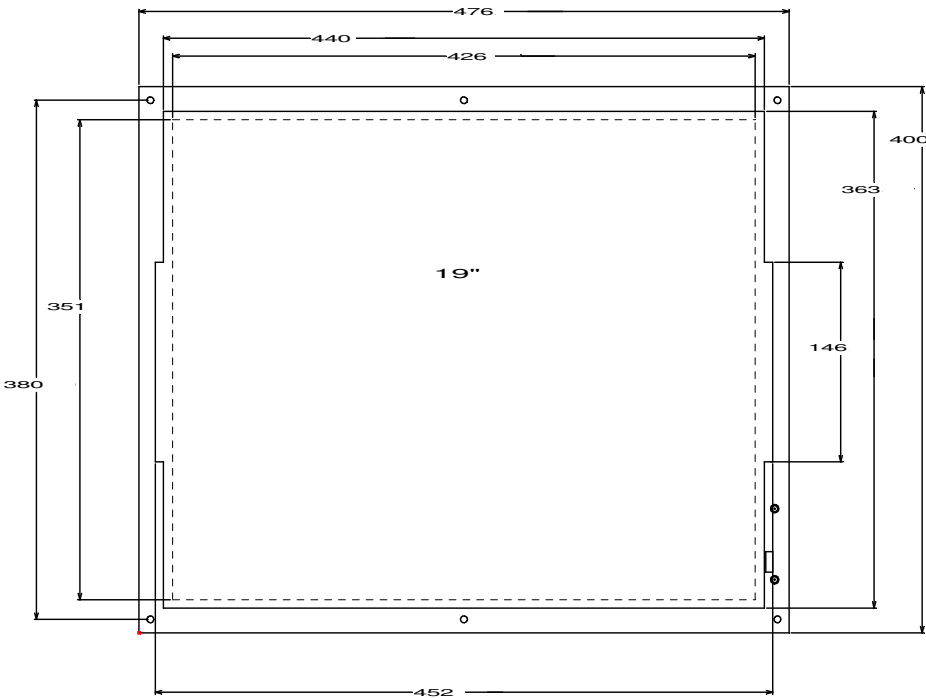



# Olorin VLD229



## 21.5" Monitor with Dimming

- 21.5" monitor with 1920 x 1080 resolution
- Dimming for night time operation
- Multiple video inputs for a variety of equipment

## Specification

<b>LCD Panel</b>	Backlight Type	WLED
	Screen Technology	AHVA
	Surface Treatment	Antiglare, Hard coating (3H)
	Screen Size, Diagonal	21.5"
	Screen Size, H/V	476.064 x 267.786 mm
	Aspect Ratio	16:9
	Resolution	1920 x 1080, FHD
	Color Depth	16.7M, 72% NTSC
	Contrast Ratio	1000:1 (Typ.) (TM)
	Luminance	350 cd/m <sup>2</sup> (Typ.)
	Viewing Angles	178 / 178 (Typ.)
	Response Time	22 ms (Typ.)
	Refresh Rate	60 Hz
<b>Display Modes</b>	Temperature	Cool, Neutral, Warm, User
<b>Features</b>	Dimming	Olorin Dimming, 0 to 100%
	Video Scaling	Full, 1:1, 4:3, 5:4, 16:9
<b>Video Inputs</b>	DisplayPort	DisplayPort x 1
	DVI	DVI-I 29 pin x1 (DVI-A/DVI-D)
	HDMI	HDMI x 1
	CVBS	BNC x 1
<b>Control Inputs</b>	Serial Command, RS-232	D-sub 9 pin x 1
	Olorin External OSD	RJ45 x 1
<b>Touch Panel</b>	Touch Type	PCAP (Optional)
	Touch Input, USB	USB-B x 1
	Touch Input, RS-232	D-sub 9 pin x 1
<b>USB</b>	Firmware Upload	Micro USB x 1
<b>Audio</b>	Audio Input	Phone Jack 3.5mm x 1
	Speakers	2W x 2
<b>Power</b>	Power Input Type	External adapter
	Power Input Rating	100-240Vac, 1.8A, 50-60 Hz
	Adapter Power Output Rating	12V 4.5 A
	DC Input	9V~36V
	DC Connector	4 Pin
	Power consumption	Full Brightness: 30W Power Saving: 2.5W

Olorin VLD229 is designed for specialists in maritime and other demanding environments where rugged equipment is of the utmost importance.

### Excellent image quality

Olorin VLD229 features a standard Full HD resolution which makes it compatible with the majority of hardware out there.

### Connectivity

Olorin VLD229 has multiple video inputs for users who want to get the most out of their monitor. It supports DisplayPort, HDMI, DVI and analog inputs such as VGA and CVBS. The monitor can also be connected to Olorin's external OSD for dimming.

This monitor also has optional PCAP multi touch for user interaction.

### Suitable for demanding environments

The monitor has a rugged construction and optional protective glass in order to be used in working environments such as maritime. Olorin VLD229 features a dimmable backlight, to make sure the operator can work even in complete darkness on the sea without having the monitor's contrast being compromised.

<b>Mechanical</b>	Dimensions w/o Base Unit	537.37 x 328.87 x 59 mm
	Weight w/o Base Unit	5.8 Kgs
	Housing Color	Black
	Housing Material	Plastic (PC+ABS)
	IP Rating *	IP 65 (Front bezel only, optional)
	Mounting Standard, VESA	100 x 100 mm
	OSD Interface	Potentiometer on Right Side
	OSD Lock	Yes
	Anti Reflective Film	N/A
	Screen Protection	Glass True Flat (Optional)
<b>Compliance</b>	Security slot	Kensington Security Slot
	Ground bolt	Potential equalization bolt
	EU	CE (EN62368-1, EN55032/EN55035, Rohs, WEEE)
	EU Energy efficiency class	G
<b>Warranty</b>	DOA	Three (3) months, max. 500 h.
	Standard	Two (2) years

## Order no. Monitor

Order no.	Order no. Dimming Kit	Description
VLD22906	VLD22906D	Default
VLD22906GTF	VLD22906DGTF	w/ Screen Protection IP65 *
VLD22906PCAP	VLD22906DPCAP	w/ PCAP Touch panel IP65 *

## Order no. Accessories

Order no.	Description
XAVLD98422	Flush mounting frame
XAVL22012	Base unit, standard desktop
XAVL98200	Multi attachment Slim
XAVL98201	Multi attachment
XAVL9850x	External OSD (1, 2 or 4 ports)
XAVL99035	DVI to VGA & DVI splitter cable
XAVL99041	12V 4-pin cable (included with Dimming Kit)

VistaLine VLD229

Measurements

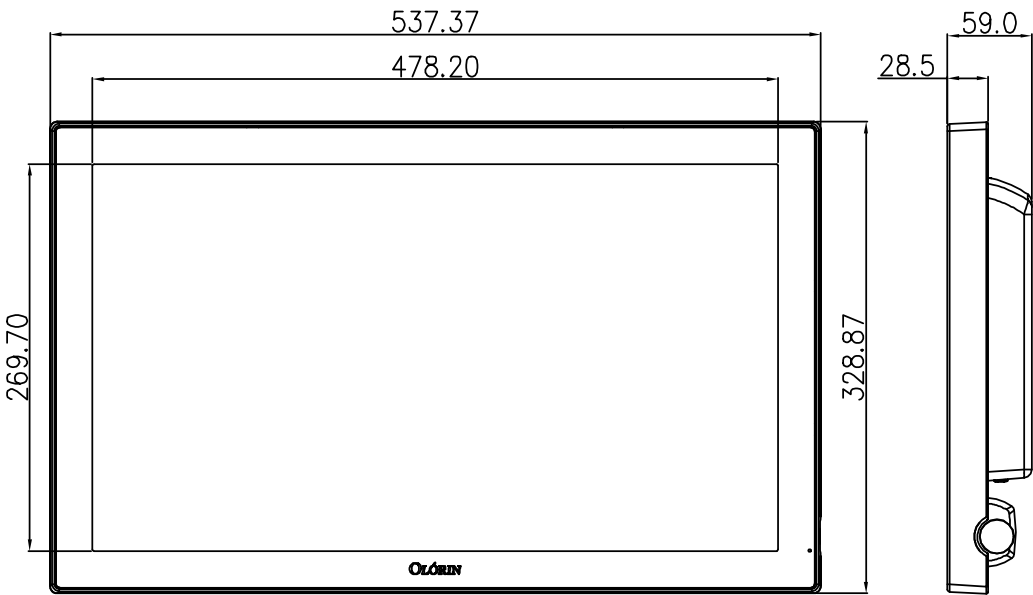

Measurements for Flush mounting frame

Order no. : XAVLD98422

	Outer dimensions	Cut out dimensions
Width	583 mm	548 mm
Height	375 mm	338 mm

Additional cut out for OSD circuit and back plate might be necessary.

